



设计人员: 焦伙平

QQ: 807948422

制作日期: 2021-7-13

运用软件: Adobe Acrobat 7 Pro

[Http://www.yattool.com](http://www.yattool.com)

名 客 料 尺 材	称:	说明书
	户:	TH003
	号:	8458-A034015001-001
	寸:	A5(148.5x210mm)
	质:	70g双胶纸

颜 页	色:	黑白印刷
	数:	4张A4纸

备注:



20V MAX LITHIUM ION CORDLESS GRASS TRIMMER

Model: GTX2-L / GTX2-L-EU

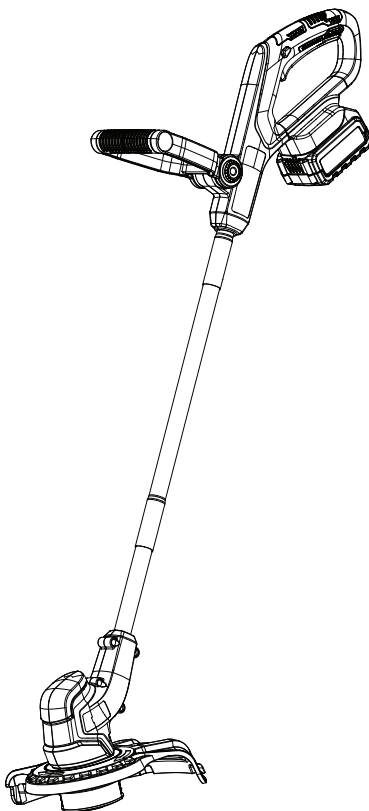

For customer service please find all information on www.senixtools.com
CAUTION: BEFORE USING THIS PRODUCT, READ THIS MANUAL AND
FOLLOW ALL ITS SAFETY RULES AND OPERATING INSTRUCTIONS.

ORIGINAL INSTRUCTIONS

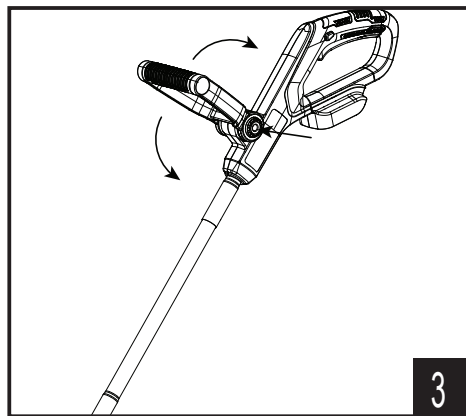
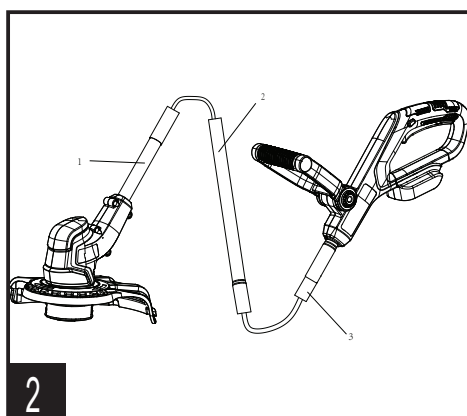
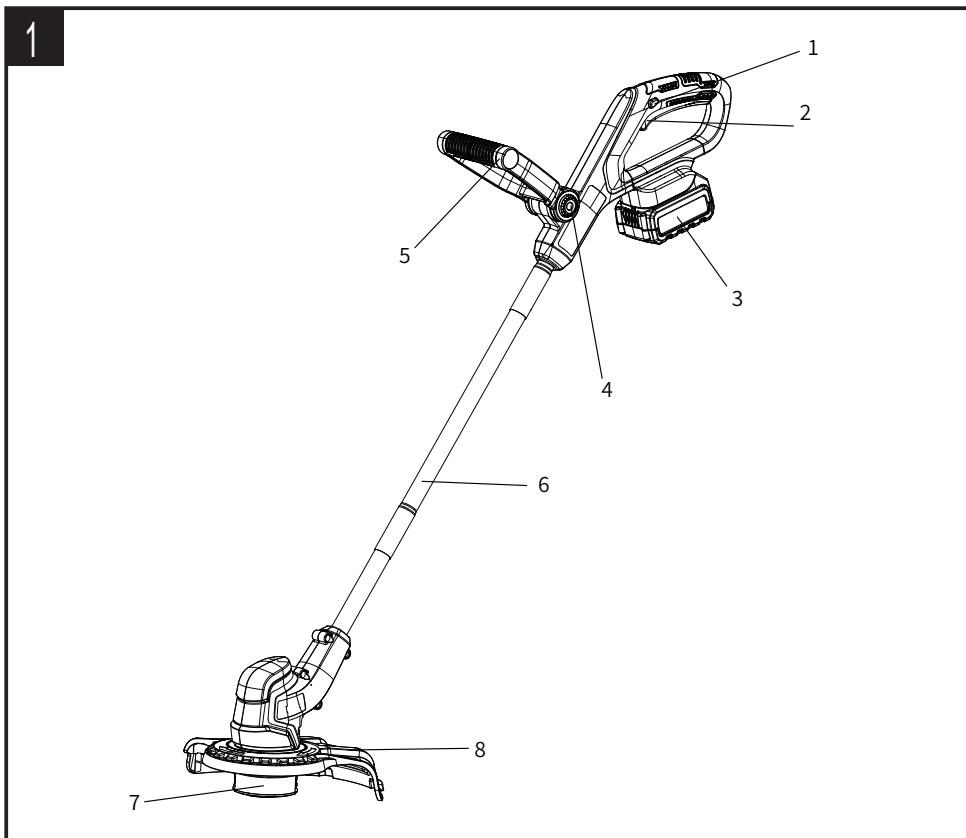

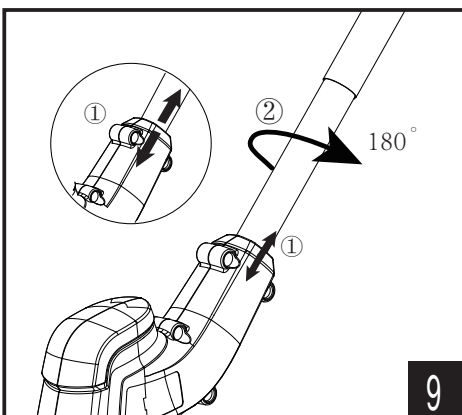
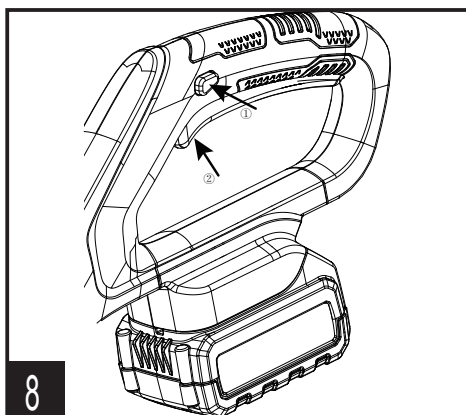
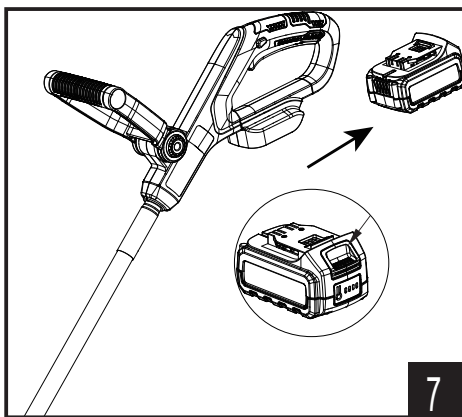
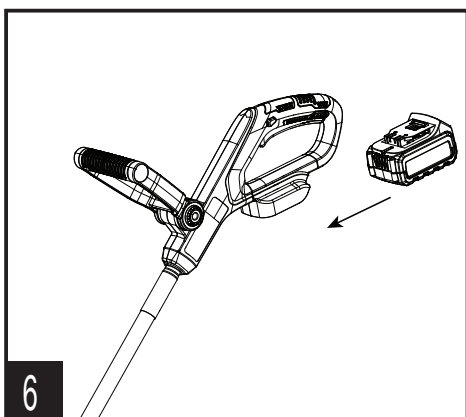
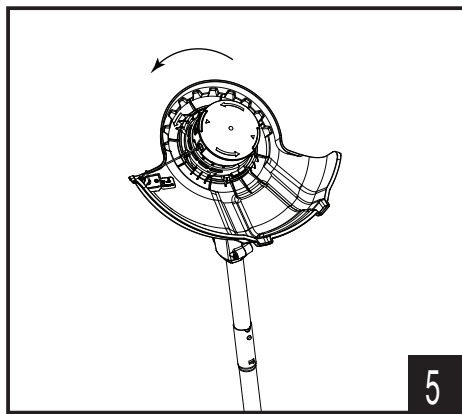
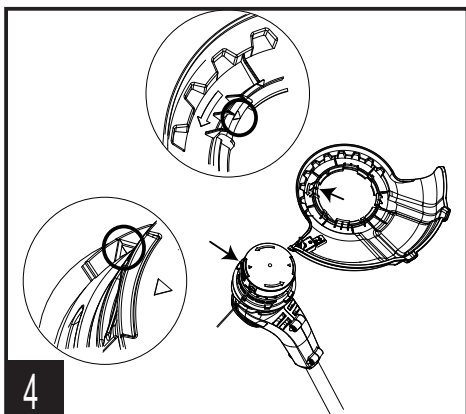

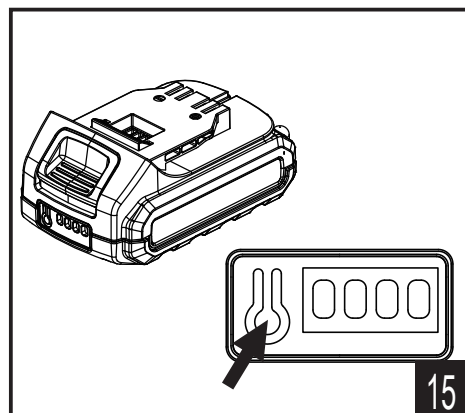
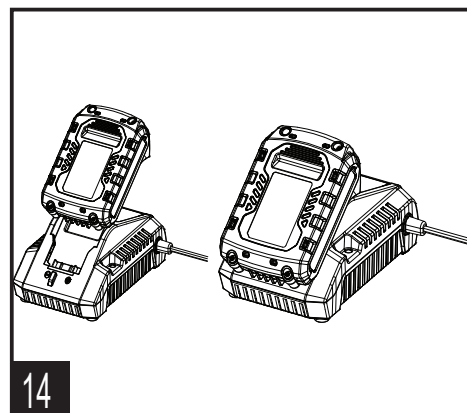
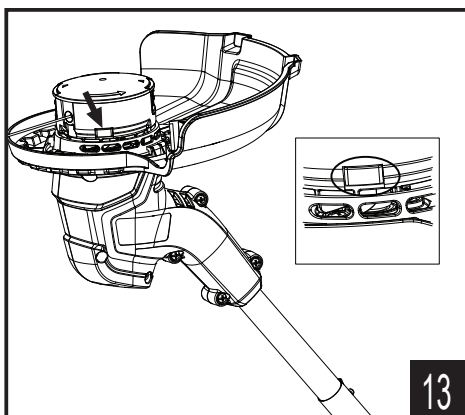
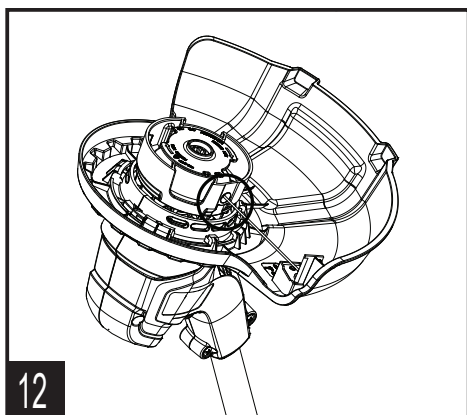
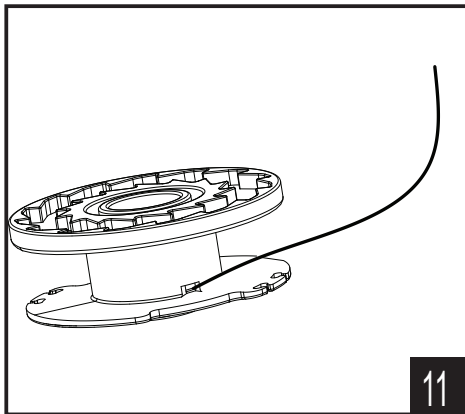
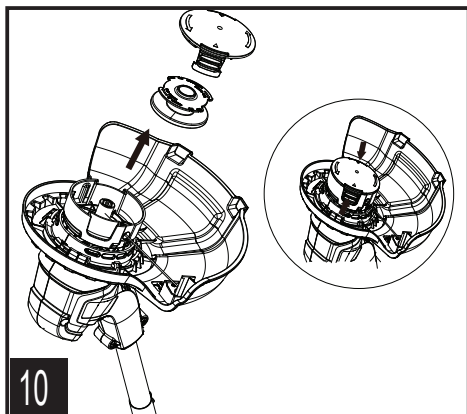

TABLE OF CONTENTS

SAFETY & INTERNATIONAL SYMBOLS	5
SAFETY INSTRUCTIONS	6
KNOW YOUR UNIT	13
SPECIFICATIONS*	13
ASSEMBLY	13
OPERATION	14
TROUBLESHOOTING	15
RECYCLING AND DISPOSAL	16

SAFETY & INTERNATIONAL SYMBOLS

Explanation of Safety & international symbols describes safety and international symbols and pictographs that may appear on this product. Read the operator's manual for complete safety, assembly, operating and maintenance and repair information.



The following symbols are used throughout this manual.

Read the manual. The manual contains information intended to draw attention to possible safety issues and deterioration of the machine as well as helpful tips for getting started, correct the machine use and maintenance. Please respect all of the warnings, explanations and instructions given in this manual for safe and optimal use of this device.



Danger! Warning! Attention!

This symbol highlights a danger, a warning or a caution. It indicates that the operator's safety is at risk.



Wear protective equipment.



Wear eye and hearing protection when using the machine.



Wear protective gloves.



Wear Sturdy, non-slip footwear.



Wear tight-fitting protective clothes.



Wear face protection!



Risk of flying objects or debris.

Be aware of that there is a risk of flying objects and/or debris when using the machine.
Keep bystanders away.



Beware of foot injury by cutting attachment.



Beware of objects flung by cutting attachments.
Never use without properly mounted protection guard.



Keep 15 meters away from any other person.



Beware of objects flung by cutting attachments.
Never use without properly mounted protection guard.



Don't install or use any type of blade on the unit displaying this symbol.



This products meets the requirements of the relevant standards.



Maximum permitted revolutions of the blade.



Do not touch the line/blade until it stops completely when replacing new blade.

SAFETY INSTRUCTIONS



WARNING:

Signals an **EXTREME** hazard. Failure to obey a safety **DANGER** symbol **WILL** result in serious injury or death to yourself or to others.



WARNING:

Crude oil, gasoline, diesel fuel and other petroleum products can expose you to chemicals including toluene and benzene, which are known to the State of California to cause cancer and birth defects or other reproductive harm. These exposures can occur in and around oil fields, refineries, chemical plants, transport and storage operations such as pipelines, marine terminals, tank trucks and other facilities and equipment. For more information go to: www.P65Warnings.ca.gov/petroleum.



WARNING:

Signals a **SERIOUS** hazard. Failure to obey a safety **WARNING** symbol **CAN** result in serious injury to yourself or to others.



NOTE:

Advises you of information or

instructions vital to the operation or maintenance of the equipment.



NOTE:

Familiarise yourself with the national regulation, it can restrict the use of the machine.



WARNING:

CALIFORNIA PROPOSITION 65

This product contains a chemical known to the state of California to cause cancer, birth defects or other reproductive harm. **Read the operator's manual and follow all warnings and safety instructions. Failure to do so can result in serious injury to the operator and/or bystanders.**

GENERAL POWER TOOL SAFETY WARNINGS TO REDUCE RISK OF INJURY



WARNING:

Wear appropriate personal hearing protection during use. Under some conditions and duration of use, noise from this product may contribute to hearing loss. Save these instructions and review frequently prior to use and in instructing others.



WARNING:

When using electric gardening appliances, basic safety precautions

should always be followed to reduce risk of fire, electric shock, and personal injury, including the following:

READ ALL INSTRUCTIONS

KEEP CHILDREN AWAY – All visitors, children and pets should stay at a safe distance from the work area.

DRESS PROPERLY – Don't wear loose clothing or jewelry. Wear protective hair covering to contain long hair. They can be caught in moving parts. Use of rubber gloves and substantial footwear is recommended when working outdoors. Always wear long pants while operating this string trimmer.

USE SAFETY GLASSES – Wear safety glasses with side shields or goggles that are marked to comply with ANSI Z87.1 standard when operating this product. Use face or dust mask if operation is dusty.

USE RIGHT APPLIANCE – Do not use appliance for any job except that for which it is intended.

REMOVE THE BATTERY FROM THE STRING TRIMMER when not in use or when servicing or cleaning. Do not leave unattended.

CHECK DAMAGED PARTS – Before further use of the string trimmer, a guard or other part that is damaged should be carefully checked

to determine that it will operate properly and perform its intended function. Check for alignment of moving parts, binding of moving parts, breakage of parts, mounting and any other condition that may affect its operation. A guard or other part that is damaged should be properly repaired or replaced call our customer service help line at 1-800-261-3981 for assistance.

LIGHTING – Only operate trimmer in daylight or good artificial light.

DON'T OVERREACH – Keep proper footing and balance at all times.



NOTE:

Do not use the string trimmer with any type of accessory or attachment. Such usage might be hazardous.

AVOID DANGEROUS

ENVIRONMENTS – Don't use trimmer in rain, damp or wet locations. Do not operate trimmer in gaseous or explosive atmospheres. Motors in these tools normally spark, and the sparks might ignite fumes.

AVOID UNINTENTIONAL

STARTING – Don't carry the string trimmer with finger on switch. Be sure switch trigger is in the locked or off position before inserting battery pack.



DANGER:

Risk of cut. Keep hands away from lines. Keep both hands on handles when power is on.



CAUTION:

Use only the following type and size battery: B25X5



DANGER:

Do not dispose of the batteries in a fire. The cell may explode. Check with local codes for possible special disposal instructions.



DANGER:

Do not open or mutilate the batteries. Released electrolyte is corrosive and may cause damage to the eyes or skin. It may be toxic if swallowed.



CAUTION:

Exercise care in handling batteries in order not to short the battery with conducting materials such as rings, bracelets, and keys. The battery or conductor may overheat and cause burns.



CAUTION:

DO NOT ATTEMPT to remove cut material or hold material to be cut when lines are moving. Make sure trimmer switch is off when clearing jammed material from guard. Do not grasp the guard or lines when picking up or holding the trimmer.



CAUTION:

Lines coast after turned off.

DON'T FORCE STRING TRIMMER

– It will do the job better and with less likelihood of a risk of injury at the rate for which it was designed.

STAY ALERT – Watch what you are doing. Use common sense. Do not operate string trimmer when you are tired or under the influence of medications, drugs or alcohol.

STORE IDLE STRING TRIMMER

INDOORS – When not in use, your string trimmer should be stored indoors in a dry and high or locked-up place, out of reach of children.

MAINTAIN TRIMMER WITH CARE

– Keep guard and handles clean for best performance and to reduce the risk of injury. Keep handles dry and free from oil and grease.



WARNING:

California Proposition 65: This product contains chemicals known to the State of California to cause cancer, birth defects or other reproductive harm.



WARNING:

Some dust created by this product could contain chemicals known to the State of California to cause cancer and birth defects or other reproductive harm. Some

examples of these chemicals are:
-chemicals in fertilizers-compounds
in insecticides, herbicides and
pesticides-arsenic and chromium
from chemically treated lumber.
Your risk from exposure to these
chemicals varies, depending on
how often you do this type of work.
To reduce your exposure to these
chemicals, wear approved safety
equipment such as dust masks that
are specially designed to filter out
microscopic particles.

LAWN TRIMMER SAFETY WARNINGS

- Never allow children, persons with reduced physical, sensory or mental capabilities or lack of experience and knowledge or people unfamiliar with these instructions to use the machine, local regulations may restrict the age of the operator.
- Never operate the machine while people, especially children, or pets are nearby.
- Inspect the entire machine for loose parts (nuts, bolts, screws, etc.) and any damage before start and operation. Repair or replace as necessary before using the machine.
- Never replace the non-metallic cutting means with metallic cutting means.
- Do not overreach and to keep the balance at all times. Always be sure of the footing on slopes. Walk when operating the power tool, never run.
- Do not touch moving hazardous parts before the battery pack is removed and the moving hazardous parts have come to a complete stop.
- Always wear eye and ear protection. Wear protective mask if necessary. Dress properly, do not wear loose clothing or jewelry that could become caught in moving parts of the unit. Safe, sturdy, nonskid footwear should always be worn. Long hair should be tied back. It is recommended that legs and feet should be covered to protect from flying debris during operation.

Remove the battery pack:

1. Whenever the machine is left by the user;
 2. Before clearing a blockage;
 3. Before checking, cleaning or working on the machine;
 4. After striking a foreign object to inspect the machine for damage;
 5. If the machine starts to vibrate abnormally, for immediately check.
- Never operate the machine with defective guards or shields, or without safety device.
 - Do not using the machine in bad weather conditions especially when there is a risk of lightning.

- Inspect the area to be cut and remove all debris that could become entangled in the nylon cutting head. Also remove any objects that the unit may throw during cutting.
- Keep guards in place and in working order.
- Keep blades sharp.
- Keep hands and feet away from cutting area.

BATTERY PACK SAFETY

WARNINGS

- Ensure the switch is in the off position before inserting battery pack. Inserting the battery pack into machines that have the switch on can cause accidents.
- Use only original battery packs intended specifically for this machine. Use of any other battery packs may create a risk of injury and fire.
- Do not open the battery. Danger of short-circuiting.
- Protect the battery against heat (e.g., against continuous intense sunlight and fire) water and moisture. Danger of explosion.
- In case of damage and improper use of the battery, vapours may be emitted. Ventilate the area and seek medical help in case of complaints. The vapours can irritate the respiratory system.
- Use the battery pack only in

conjunction with this product and/or product family. This measure alone protects the battery against dangerous overload.

- The battery can be damaged by pointed objects such as nails or screwdrivers or by force applied externally. An internal short circuit can occur and the battery can burn, smoke, explode or overheat.
- Do not short-circuit the battery. There is danger of explosion.
- Store and use the battery only within a temperature range between $-20\text{ }^{\circ}\text{C}$ to $50\text{ }^{\circ}\text{C}$. As an example, do not leave the battery in the car in summer.
- Occasionally clean the venting slots and contact pins of the battery pack using a soft, clean and dry brush.

BATTERY CHARGER SAFETY

WARNINGS

Read all safety warnings and instructions before using the charger. Only for indoor use!

- This appliance is not intended for use by children and persons with physical, sensory or mental limitations or a lack of experience or knowledge. This appliance can be used by children aged from 8 years and above and persons with reduced physical, sensory or mental

capabilities or lack of experience and knowledge if they have been given supervision or instruction concerning use of the appliance in a safe way and understand the hazards involved. Children shall not play with the appliance. Cleaning and user maintenance shall not be made by children without supervision.

- The supply cord cannot be replaced. If the cord is damaged the appliance should be scrapped.

- Only charge the Lithium-Ion battery pack with a capacity of 2.5 Ah (36VDC, 2500m Ah Lithium-Ion battery cells) as mentioned in this instruction manual. Do not charge non-rechargeable batteries.

- The battery and charger must be placed in a well ventilated area.

- If the supply cord is damaged, it must be replaced by the manufacturer, its service agent or similarly qualified persons in order to avoid a hazard.

- Do not operate the battery charger on easily inflammable surfaces (e. g., paper, textiles, etc.) or surroundings. The heating of the battery charger during the charging process can pose a fire hazard.

- Do not cover the ventilation slots of the battery charger. Otherwise, the battery charger can overheat and no longer operate properly.

EMERGENCY

Familiarize yourself with the use of this product by means of this instruction manual. Memorize the safety directions and follow them to the letter. This will help to prevent risks and hazards.

1. Always be alert when using this product, so that you can recognize and handle risks early. Fast intervention can prevent serious injury and damage to property.

2. Switch off the product and remove the battery pack if there are malfunctions. Have the product checked by a qualified professional and repaired, if necessary, before you operate it again.

INTENDED USE

The garden tool is intended for domestic use, for trimming grass, weeds and nettles. It is designed for trimming grass growing on slopes, under obstacles and lawn edges that cannot be reached by the lawn mower. The garden tool is not designed for use as a brush cutter. The garden tool is not intended for commercial or industrial use.

RESIDUAL RISKS

Even if you are operating this product

in accordance with all the safety requirements, potential risks of injury and damage remain. The following dangers can arise in connection with the structure and design of this product:

1. Health defects resulting from vibration emission if the product is being used over long periods of time or not adequately managed and properly maintained.
2. Injuries and damage to property due to broken attachments or the sudden impact of hidden objects during use.
3. Danger of injury and property damage caused by flying objects.
4. Prolonged use of this product expose the operator to vibrations and may produce 'whitefinger' disease. In order to reduce the risk, please wear gloves and keep your hands warm. If any of the 'whitefinger' symptoms appear, seek medical advice immediately.

'Whitefinger' symptoms include: numbness, loss of feeling, tingling, pricking, pain, loss of strength, changes in skin colour or condition. These symptoms normally appear in the fingers, hands or wrists. The risk increases at low temperatures.



WARNING:

This product produces an

electromagnetic field during operation! This field may under some circumstances interfere with active or passive medical implants! To reduce the risk of serious or fatal injury, we recommend persons with medical implants to consult their doctor and the medical implant manufacturer before operating this product!

KNOW YOUR UNIT

APPLICATIONS

Model: GTX2-L-EU/GTX2-L-EU-0

As a cordless grass trimmer:

- Trimming grass, weeds and nettles.

1	Lock-Off Button for On/Off Switch
2	On/Off Switch
3	Battery Pack
4	Handle-Adjustment Button
5	Auxiliary Handle
6	Connecting Tube
7	Trimmer Head
8	Protection Guard

SPECIFICATIONS*

GTX2-L-EU include the charger and the battery pack.

GTX2-L-EU-0 does not include the charger and the battery pack.

Rated Voltage	20V max d.c.
No load speed (min-1):	8500RPM±10%
Rated Power	200W
Cutting Line Diameter	1.6mm
Cutting Diameter	26cm
Cutting Spool Capacity	3m
Product Dimensions	1140*400*270mm
Weight without Battery	1.7kg

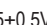
Battery pack model number	B25X2
Rated voltage	18V 
Rated capacity	2.5Ah
Weight	Approx. 0.335g
Charger model number	CHX2
Rated input	100-240V ~ 50/60Hz
Rated output	22.5±0.5V  , 2±0.2A

Charging time (with 2.5 Ah battery)	90mins
Protection class	 / II
Weight	Approx. 0.34kg

ASSEMBLY

1. Unpack all parts and lay them on a flat, stable surface:
2. Remove all packing materials and shipping devices, if applicable.
3. The scope of delivery varies depending on the country and purchased variant: Model of GTX2-L-EU/GTX2-L-EU-0.
4. If you find that parts are missing or show damage do not use the product but contact your dealer. Using an incomplete or damaged product represents a hazard to people and property.
5. Ensure that you have all the accessories and tools needed for assembly and operation. This also includes suitable personal protective equipment.



WARNING:

Wear protective gloves for this assembly work and always lay the product on a flat and stable surface while assembling.

Follow the assembly instructions step-by-step and use the pictures provided as a visual guide to easily assemble the product!

MOUNTING THE CONNECTING TUBE

1. Align the hole on the lower connecting tube(1) with the hole on the middle connecting tube(2), connect them and make sure they are well engaged.
2. connect the upper connecting tube(3) and middle connecting tube (Fig. 2).



WARNING:

Caution: Switch the garden tool off and remove the battery before performing any maintenance.

MOUNTING THE AUXILIARY HANDLE

Keep the handle-Adjustment button being pressed, fix the auxiliary handle to the trimmer.

To change different positions, press the handle-Adjustment button and move the handle to the desired position. Release the button so that the handle can be engaged (Fig. 3).

MOUNTING THE PROTECTION GUARD

Find the small arrows on the trimmer head and the protection guard, put them together (Fig. 4).

Rotate the protection guard counterclockwise until it is firmly in place (Fig. 5).

INSTALLING THE BATTERY PACK



NOTE:

Using unsuitable batteries can lead to malfunctions or damage the machine.

Insert the charged battery. Ensure the battery is inserted correctly (Fig. 6).

To remove the battery from the machine, press the battery unlocking button and pull the battery out (Fig. 7).

OPERATION

SWITCHING ON/OFF

Press the lock-off button and hold it in position at first. Then Press the on/off switch to switch the product on. Release the lock-off button once the product is running. Release the on/off switch to switch the product off (Fig. 8).

WINDING UP THE CUTTING LINE



NOTE:

Remove the battery before replacing the spool.

Press both latches of the spool cover together and remove the spool cover. Afterwards, remove the empty spool (Fig. 10).

Select a line of approx. 5.0m for refilling the spool.

Slide one end of the cutting line into the hole for line wind-up in the spool and wind up the cutting line uniformly and tightly (Fig. 11).

Slide the other end of the cutting line through the hole for line guiding in the trimmer head (Fig. 12).

Mount the spool back into the trimmer head and affix the spool by reinstalling the spool cover at last.

LINE FEEDING

Semi-automatic Line Feeding

The trimmer is equipped with a semi-automatic feeding system. The system feeds line with every press of the on/off switch.

Manual Line Feeding

Press the line-feed button can adjust the line to desired length (Fig. 13).

HOW TO CHARGE THE BATTERY PACK



WARNING:

This Lithium-Ion battery pack is shipped partially charged. Fully charge the battery pack before using it for the first time.

1. Charge the Lithium-Ion battery pack only with the correct charger.
2. Connect the charger to a power supply, the light indicator of the charger turns red.
3. Align the raised ribs of the battery pack with the slot in the charger.
4. Insert the battery pack into the charger, the light indicator of the charger turns green and it flashes.
5. The charger will communicate with the battery pack to evaluate the condition of the battery pack (Fig.14).
6. It is fully charged that the four lights of the battery turn on. Disconnect the power supply from the charger. Remove battery pack from the charger.

CHARGING INDICATOR

Press the light button (Fig. 15) to check the battery pack whether needs to charge.

Lights			Status
Lighted	Off	Blinking	
			The battery is at full capacity.
			The battery is at 75% capacity.
			The battery is at 50% capacity and requires charging.
			The battery is at 25% capacity and requires charging soon.
			The battery is less than 5% capacity and requires charging immediately.



WARNING:

Malfunctions may occur when the four lights blinking in turns.

OVERHEAT PROTECTION

When the tool/battery is overheated, the tool stops automatically. In this situation, let the power tool/battery cool before turning the tool on again.

OVERDISCHARGE PROTECTION

When the battery capacity is not enough, the tool stops automatically. In this case, remove the battery from the tool and charge the battery.

LAWN TRIMMING

Stand in the operating position. Stand up straight. Do not bend over. Keep feet apart and firmly planted.

Move the trimmer left and right, keeping it well away from the body. Cut all grass from top to down.

Inspect the working area and remove all debris that may be entangled in the cutting head. Also remove any objects that product may throw during cutting.

If the cutting head is wrapped around with grass, stop the trimmer and clean up.

Avoid trees, flowers, stones, walls and other objects which can cause the line to break.

Check and feed the line regularly to maintain full cutting width and performance.

Edging Trimming:

Make a gently rotation of 180° when the connecting tube in an extended situation to adjust trimming angle under some special circumstances (Fig. 9).

Ensure the trimmer head is accurately positioned before every trimming.

NOTE: Some line breakage will occur from:

- Entanglement with foreign matter
- Normal line fatigue
- Attempting to cut thick vegetation
- Forcing the line into objects such as walls or fence posts

TROUBLESHOOTING

Suspected malfunctions are often due to causes that the users can fix themselves. Therefore, check the product using this section. In most cases the problem can be solved quickly.

PROBLEM	POSSIBLE CAUSE	SOLUTION
Product does not start	Battery pack not properly attached	Attach properly
	Battery too hot/cold	Allow to cool/warm
	Battery pack discharged	Charge the battery pack
Product does not cut	Cutting line too short/broken off	Manually feed cutting line
	Spool empty	Replace line spool
Cutting line can no longer be fed	Line inside the spool entangled	Inspect the spool, rewind if necessary
	Spool empty	Refill line spool
Cutting line breaks frequently	Line inside the spool entangled	Remove spool – rewind line
	Trimmer used incorrectly	Only trim with the tip of the line, avoid stones, walls and other hard objects. Feed the line regularly to maintain full cutting diameter.
Heavy vibrations	Cutting line broken	Pull out cutting line with manual feed
	Cutting system damaged	Have the product repaired by a qualified service.
	Grass between spool housing and line-feed button	Disassemble spool cover and remove grass
	Grass in hole for line feed	Remove grass from hole for line feed

RECYCLING AND DISPOSAL



Disposal of waste electric and electronic equipment (WEEE)

Waste electric and electronic equipment shall not be disposed of with household waste.

Please recycle where facilities exist. Check with your local authority for recycling advice.



Disposal of defective or used battery pack

Discharge your battery pack by operating your tool, then remove the battery pack from the tool. Cover the battery pack connections with heavy duty adhesive tape to prevent short circuit and energy discharge.

Do not attempt to open or remove any of the components.

Batteries and battery packs shall not be disposed of with household waste. Consult your local waste authority for information regarding available recycling and/or disposal options.