



设计人员: 梁光灿

邮箱: guangcan.liang@yat.com

制作日期: 2023-03-15

运用软件: Adobe Acrobat 9 Pro

TEL:0573-83225888-503 [Http://www.yattool.com](http://www.yattool.com)

名称: 说明书
客户: CH192
料号: **8458-B063006001-001**
成品尺寸: **A5(148.5x210mm)**
材质: 70g双胶纸

颜色: **黑白印刷**
页数: 4张A4纸

备注:



材质符合欧盟包装指令 (94/62/EC)



20V MAX CORDLESS ROTARY HAMMER

Model: PDRX2-M2-EU

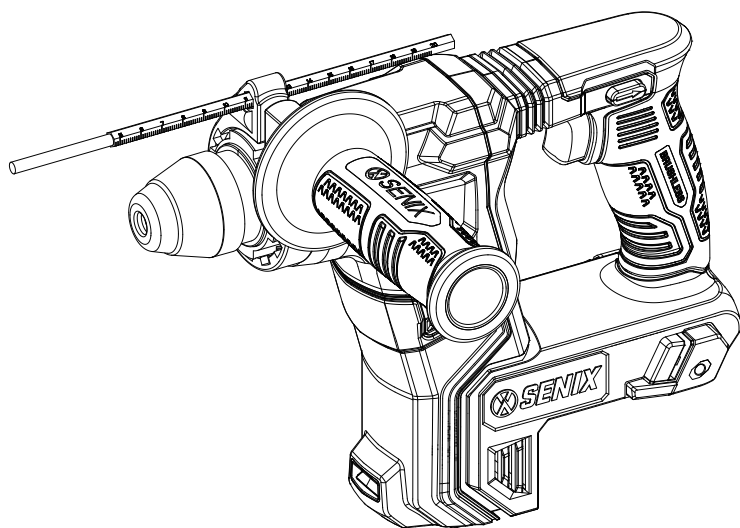

For customer service please find all information on www.senixtools.com
CAUTION: BEFORE USING THIS PRODUCT, READ THIS MANUAL AND
FOLLOW ALL ITS SAFETY RULES AND OPERATING INSTRUCTIONS.

ORIGINAL INSTRUCTIONS

TABLE OF CONTENTS

SAFETY & INTERNATIONAL SYMBOLS	2
SAFETY INSTRUCTIONS.....	3
KNOW YOUR UNIT.....	6
SPECIFICATIONS.....	7
ASSEMBLY.....	8
OPERATION.....	11
MAINTENANCE.....	13
TROUBLESHOOTING.....	14

SAFETY & INTERNATIONAL SYMBOLS

Explanation of safety & international symbols describes safety and international symbols and pictographs that may appear on this product. Read the instruction manual for complete safety, assembly, operating and maintenance and repair information.



Caution / Warning.



To reduce the risk of injury, user must read instruction manual.



Wear eye protection.



Wear hearing protection.



Wear a dust mask.



Wear safety footwear.



Wear protective gloves.



Keep bystanders a safe distance away from the work area.

SAFETY INSTRUCTIONS

GENERAL POWER TOOL SAFETY WARNINGS



WARNING!

Read all safety warnings, instructions, illustrations and specifications, provided with this power tool. Failure to follow all instructions listed below may result in electric shock, fire and/or serious injury.

Save all warnings and instructions for future reference.

The term "power tool" in the warnings refers to your mains-operated (corded) power tool or battery-operated (cordless) power tool.

1) Work Area Safety

- a) Keep work area clean and well lit. Cluttered or dark areas invite accidents.
- b) Do not operate power tools in explosive atmospheres, such as in the presence of flammable liquids, gases or dust. Power tools create sparks which may ignite the dust or fumes.
- c) Keep children and bystanders away while operating a power tool. Distractions can cause you to lose control.

2) Electrical Safety

- a) Power tool plugs must match the outlet. Never modify the plug in any way. Do not use any adapter plugs with earthed (grounded) power tools. Unmodified plugs and matching outlets will reduce risk of electric shock.
- b) Avoid body contact with earthed or grounded surfaces, such as pipes, radiators, ranges and refrigerators. There is an increased risk of electric shock if your body is earthed or grounded.
- c) Do not expose power tools to rain or wet conditions. Water entering a power tool will increase the risk of electric shock.
- d) Do not abuse the cord. Never use the cord for carrying, pulling or unplugging the power tool. Keep cord away from heat, oil, sharp edges or moving parts. Damaged or entangled cords increase the risk of electric shock.
- e) When operating a power tool outdoors, use an extension cord suitable for outdoor use. Use of a cord suitable for outdoor use reduces the risk of electric shock.

- f) If operating a power tool in a damp location is unavoidable, use a residual current device (RCD) protected supply. Use of an RCD reduces the risk of electric shock.

3) Personal Safety

- a) Stay alert, watch what you are doing and use common sense when operating a power tool. Do not use a power tool while you are tired or under the influence of drugs, alcohol or medication. A moment of inattention while operating power tools may result in serious personal injury.
- b) Use personal protective equipment. Always wear eye protection. Protective equipment such as a dust mask, non-skid safety shoes, hard hat or hearing protection used for appropriate conditions will reduce personal injuries.
- c) Prevent unintentional starting. Ensure the switch is in the off-position before connecting to power source and/or battery pack, picking up or carrying the tool. Carrying power tools with your finger on the switch or energising power tools that have the switch on invites accidents.
- d) Remove any adjusting key or wrench before turning the power tool on. A wrench or a key left attached to a rotating part of the power tool may result in personal injury.
- e) Do not overreach. Keep proper footing and balance at all times. This enables better control of the power tool in unexpected situations.
- f) Dress properly. Do not wear loose clothing or jewellery. Keep your hair and clothing away from moving parts. Loose clothes, jewellery or long hair can be caught in moving parts.
- g) If devices are provided for the connection of dust extraction and collection facilities, ensure these are connected and properly used. Use of dust collection can reduce dust-related hazards.
- h) Do not let familiarity gained from frequent use of tools allow you to become complacent and ignore tool safety principles. A careless action can cause severe injury within a fraction of a second.

4) Power Tool Use And Care

- a) Do not force the power tool. Use the correct

power tool for your application. The correct power tool will do the job better and safer at the rate for which it was designed.

- b) Do not use the power tool if the switch does not turn it on and off. Any power tool that cannot be controlled with the switch is dangerous and must be repaired.
- c) Disconnect the plug from the power source and/or remove the battery pack, if detachable, from the power tool before making any adjustments, changing accessories, or storing power tools. Such preventive safety measures reduce the risk of starting the power tool accidentally.
- d) Store idle power tools out of the reach of children and do not allow persons unfamiliar with the power tool or these instructions to operate the power tool. Power tools are dangerous in the hands of untrained users.
- e) Maintain power tools and accessories. Check for misalignment or binding of moving parts, breakage of parts and any other condition that may affect the power tool's operation. If damaged, have the power tool repaired before use. Many accidents are caused by poorly maintained power tools.
- f) Keep cutting tools sharp and clean. Properly maintained cutting tools with sharp cutting edges are less likely to bind and are easier to control.
- g) Use the power tool, accessories and tool bits etc. in accordance with these instructions, taking into account the working conditions and the work to be performed. Use of the power tool for operations different from those intended could result in a hazardous situation.
- h) Keep handles and grasping surfaces dry, clean and free from oil and grease. Slippery handles and grasping surfaces do not allow for safe handling and control of the tool in unexpected situations.

5) Battery Tool Use And Care

- a) Recharge only with the charger specified by the manufacturer. A charger that is suitable for one type of battery pack may create a risk of fire when used with another battery pack.
- b) Use power tools only with specifically designated battery packs. Use of any other battery packs may create a risk of injury and fire.

- c) When battery pack is not in use, keep it away from other metal objects, like paper clips, coins, keys, nails, screws or other small metal objects, that can make a connection from one terminal to another. Shorting the battery terminals together may cause burns or a fire.
- d) Under abusive conditions, liquid may be ejected from the battery; avoid contact. If contact accidentally occurs, flush with water. If liquid contacts eyes, additionally seek medical help. Liquid ejected from the battery may cause irritation or burns.
- e) Do not use a battery pack or tool that is damaged or modified. Damaged or modified batteries may exhibit unpredictable behaviour resulting in fire, explosion or risk of injury.
- f) Do not expose a battery pack or tool to fire or excessive temperature. Exposure to fire or temperature above 130°C may cause explosion.
- g) Follow all charging instructions and do not charge the battery pack or tool outside the temperature range specified in the instructions. Charging improperly or at temperatures outside the specified range may damage the battery and increase the risk of fire.

6) Service

- a) Have your power tool serviced by a qualified repair person using only identical replacement parts. This will ensure that the safety of the power tool is maintained.
- b) Never service damaged battery packs. Service of battery packs should only be performed by the manufacturer or authorized service providers.

CORDLESS ROTARY HAMMER SAFETY WARNINGS

- a) Wear ear protectors. Exposure to noise can cause hearing loss.
- b) Use auxiliary handle(s), if supplied with the tool. Loss of control can cause personal injury.
- c) Hold power tool by insulated gripping surfaces, when performing an operation where the cutting accessory may contact hidden wiring. Cutting accessory contacting a "live" wire may make exposed metal parts of the power tool "live" and could give the operator an electric shock.

- d) Wear a hard hat (safety helmet), safety glasses and/or face shield. Ordinary eye or sun glasses are NOT safety glasses. It is also highly recommended that you wear a dust mask and thickly padded gloves.
- e) Be sure the bit is secured in place before operation.
- f) Under normal operation, the tool is designed to produce vibration. The screws can come loose easily, causing a breakdown or accident. Check tightness of screws carefully before operation.
- g) In cold weather or when the tool has not been used for a long time, let the tool warm up for a while by operating it under no load. This will loosen up the lubrication. Without proper warm-up, hammering operation is difficult.
- h) Always be sure you have a firm footing. Be sure no one is below when using the tool in high locations.
- i) Hold the tool firmly with both hands.
- j) Keep hands away from moving parts.
- k) Do not leave the tool running. Operate the tool only when hand-held.
- l) Do not point the tool at any one in the area when operating. The bit could fly out and injure someone seriously.
- m) Do not touch the bit, parts close to the bit, or workpiece immediately after operation; they may be extremely hot and could burn your skin.
- n) Some material contains chemicals which may be toxic. Take caution to prevent dust inhalation and skin contact.



WARNING!

DO NOT let comfort or familiarity with product (gained from repeated use) replace strict adherence to safety rules for the subject product. MISUSE or failure to follow the safety rules stated in this instruction manual may cause serious personal injury.

SAFETY INSTRUCTIONS WHEN USING LONG DRILL BITS WITH ROTARY HAMMERS

- a) Always start drilling at low speed and with the bit tip in contact with the workpiece. At higher speeds, the bit is likely to bend if allowed to rotate freely without contacting the workpiece, resulting in personal injury.
- b) Apply pressure only in direct line with the bit and do not apply excessive pressure.

Bits can bend, causing breakage or loss of control, resulting in personal injury.

VIBRATION + NOISE REDUCTION

To reduce the impact of noise and vibration emission, limit the time of operation, use low-vibration and low-noise operating modes as well as wear personal protective equipment. Take the following points into account to minimise the vibration and noise exposure risks.

- Only use the product as intended by its design and these instructions.
- Ensure that the product is in good condition and well maintained.
- Use correct attachments for the product and ensure they are in good condition.
- Keep tight grip on the handles/grip surface.
- Maintain this product in accordance with these instructions and keep it well lubricated (where appropriate).
- Plan your work schedule to spread any high vibration tool use across a longer period of time.

EMERGENCY

Familiarize yourself with the use of this product by means of this instruction manual. Memorize the safety directions and follow them to the letter. This will help to prevent risks and hazards.

- Always be alert when using this product, so that you can recognize and handle risks early. Fast intervention can prevent serious injury and damage to property.
- Switch off the product and remove the battery pack if there are malfunctions. Have the product checked by a qualified professional and repaired, if necessary, before you operate it again.

INTENDED USE

This rotary hammer is intended for drilling in materials such as wood, metal, plastic, concrete and masonry. Do not use it for other purposes.

KNOW YOUR UNIT

APPLICATIONS

Model: PDRX2-M2-EU

As a cordless rotary hammer:

Drilling in wood, metal, plastic, concrete and masonry.

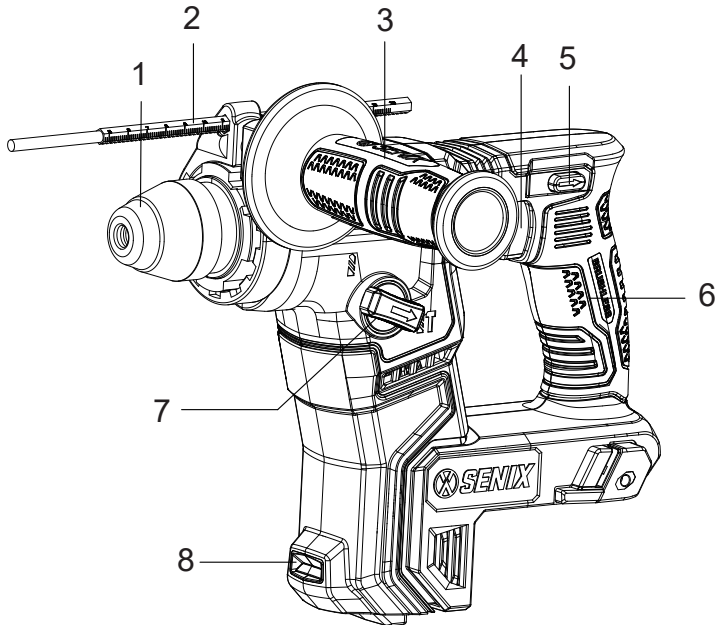

- 1. Chuck Cover
- 2. Depth Gauge
- 3. Auxiliary Handle
- 4. Variable Speed Trigger

- 5. Forward/Reverse Switch
- 6. Main Handle
- 7. Mode Selector
- 8. Work Lamp

SPECIFICATIONS

Model	PDRX2-M2-EU
Rated voltage	18 V  (20 V Max*)
No load speed(RPM)	0 - 810 rpm
No load frequency(BPM)	0 - 4500 bpm
Drilling capacities	Concrete: 17 mm
	Steel: 10 mm
	Wood: 13 mm
Weight without battery	1.7 Kg
Battery model	B20X2 B25X2 B40X2 B50X2 B80X2
Charger model	CHX2 CHQX2 CHQX2-M CHDX2-M
Ambient temperature for use	-20°C ~ 50°C
Ambient temperature for charging	0°C ~ 40°C

* 20V Max battery, maximum initial battery voltage (measured without a workload) is 20 volts.
The nominal voltage is 18.

ASSEMBLY

1. Unpack all parts and lay them on a flat, stable surface:
2. Remove all packing materials and shipping devices, if applicable.
3. The scope of delivery varies depending on the country and purchased variant.

Model of PDRX2-M2-EU

- Rotary hammer x1
 - Belt clip x1
 - Screw X1
 - Dust cup x1
 - Dust cup holder x1
 - Spacer(attached) x1
 - Auxiliary handle x1
 - Depth gauge x1
 - Instruction manual x1
4. If you find that parts are missing or show damage do not use the product but contact your dealer. Using an incomplete or damaged product represents a hazard to people and property.
 5. Ensure that you have all the accessories and tools needed for assembly and operation. This also includes suitable personal protective equipment.



WARNING:



Wear protective gloves for this assembly work and always lay the product on a flat and stable surface while assembling.



Follow the assembly instructions step-by-step and use the pictures provided as a visual guide to easily assemble the product!
Do not insert the battery pack before the power tool is completely assembled or adjusted!

BELT CLIP

The Belt Clip is intended for temporarily hanging the tool. It can be installed on either side of the tool.

Align and secure the Belt Clip on the tool by a screw (Fig.1).

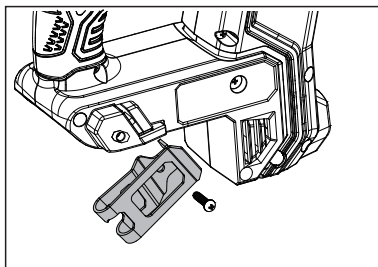

Fig.1

AUXILIARY HANDLE



WARNING:

Always use the Auxiliary Handle to ensure safe operation.

The Auxiliary Handle(3) can be fixed at desired angle.

Push the Spacer(9) to the tool and rotate it until it is secured if it is not attached from manufacturer. Fit the Bracket(10) on the Spacer(9). Then screw the Auxiliary Handle(3) on the Bracket(10) to reinforce the grip of the Bracket(10) on tool (Fig.2).

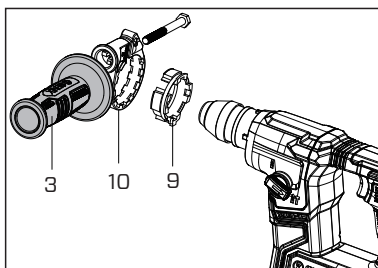

Fig.2

DEPTH GAUGE

The use of Depth Gauge(2) is conducive to drill holes in uniform depth.

Loosen Auxiliary Handle(3) and insert the Depth Gauge(2) to the hole. Make sure it does not touch the body of the tool. Adjust to desired depth then tighten the Auxiliary Handle(3) to hold the Depth Gauge(2) (Fig.3).

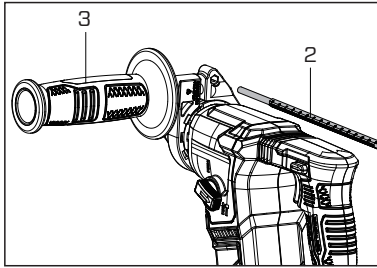

Fig.3

DUST CUP

As an optional accessory, the Dust Cup(12) is intended to prevent dust from falling over when performing overhead drilling operations. Attach the Dust Cup(12) on the Dust Cup Holder(11). Then align and fit the Dust Cup Holder(11) on the spacer (Fig.4).

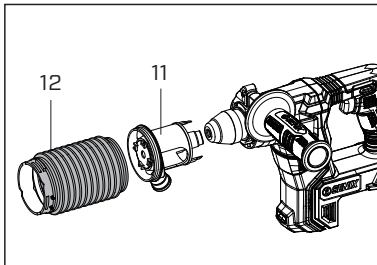

Fig.4

The Dust Cup Holder(11) is designed with a Connector(13) for vacuum cleaner. Remove the Dust Cap(14) before connection (Fig.5).

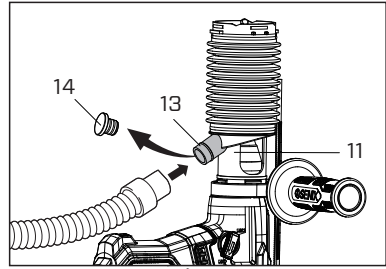

Fig.5

DRILL BIT

To install, insert the Drill Bit(15) into the Chuck Cover(1) until it engages. After that, always make sure it is held tightly in place by pulling it out.

To remove, pull the Chuck Cover(1) down all the way and pull the Drill Bit(15) out (Fig.6).

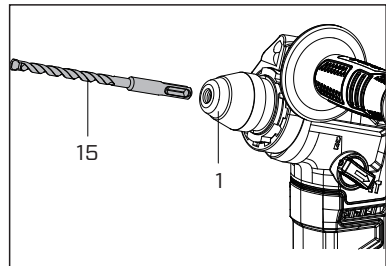

Fig.6

The tool is designed with an exposed Chuck Cover(1) when it is attached with the dust cup set. Pull the Chuck Cover(1) down to mount or remove the Drill Bit(15) (Fig.7).

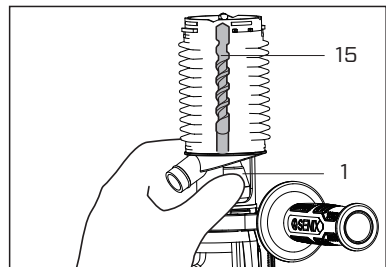

Fig.7

BATTERY PACK



NOTE:

Prior to installation, lock the variable speed trigger by forward/reverse switch to avoid unintentional start.

To install:

Align and slide the Battery Pack to the docking port until it is locked (Fig.8).

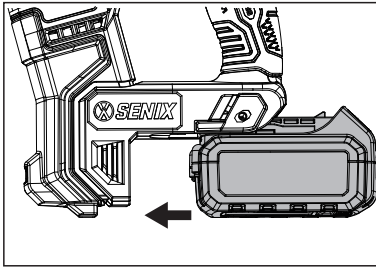

Fig.8

To remove:

Press the Rail Lock Release Button and slide the battery pack out (Fig.9).

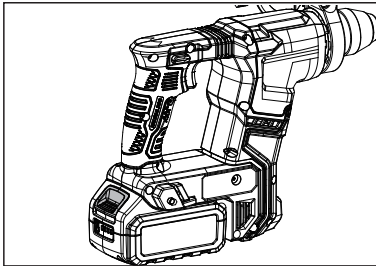

Fig.9

Note: The remaining power can be displayed through the capacity indicators on the battery which are illuminated by the button the battery. Follow below steps if the battery needs to be charged:

1. Plug the charger into a proper power supply and the charging indicator on the charger turns red.
2. Press down on the battery pack to be sure the contacts on the battery pack engage properly with contacts in the charger.

3. The charging indicator flashes green if the battery pack is well connected to the charger.
4. Unplug the charger from the power supply when the charging indicator stops flashing and remains green.
5. Remove the battery pack from the charger and check for the fully charged status.



WARNING:

In order to obtain the longest possible battery life, charge the battery when the ambient temperature is 0°C-40°C.

Refer to the BATTERY/CHARGER INSTRUCTION MANUAL for more charging information.

OPERATION



WARNING:

Always wear eye, hearing, hand protection to reduce the risk of injury when operating the tool. Keep all parts of your body away from the rotating bit.

ROTATION DIRECTION

The motor runs forward or backward for driving the bit in or out. It is controlled by the Forward/Reverse Switch. Depress the Forward/Reverse Switch as A shown for the forward rotation. On the contrary, depress the switch as B shown for the reverse rotation. To prevent intentional start when tool is not in use, turn the Forward/Reverse Switch to the neutral position to lock the trigger (Fig.10).

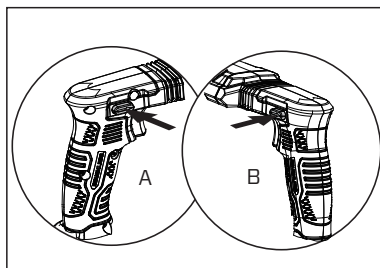

Fig.10



WARNING:

Do not change rotation direction while the product is running. Wait for a complete stop before performing setting.

ACTION MODE

The tool can be used to drill in different materials, but action mode varies. Find the suitable action mode for different applications in below table and rotate the Mode Selector until the arrow points at desired symbol (Fig.11).

Symbol	Action Mode	Application
	Rotation Only	Drill in wood, metal or plastic materials.
	Rotation with Hammering	Drill in concrete, masonry, etc.

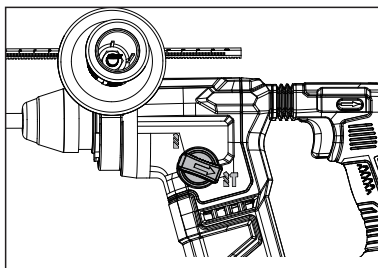

Fig.11

SWITCHING ON/OFF



WARNING:

Always grip the auxiliary handle and main handle by both hands during operation (Fig.12).

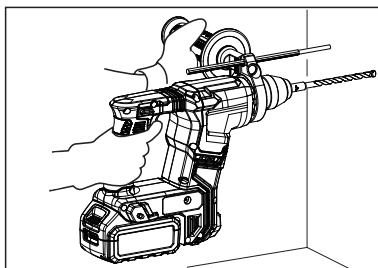

Fig.12

To start the tool, pull the Variable Speed Trigger. Tool accelerates when increasing pressure on the Trigger. To stop the tool, simply release the Trigger (Fig.13).

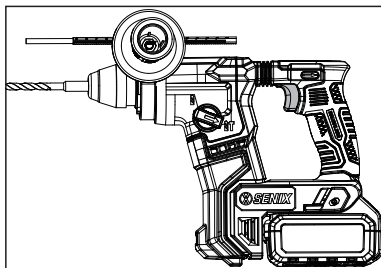

Fig.13

NOTE: Always lock the Variable Speed Trigger when the tool is not in use or before storage.

WORK LAMP

The tool is designed with a Lamp for working in dim areas. It lights up when the trigger is pulled and goes out automatically after the trigger is released (Fig.14).

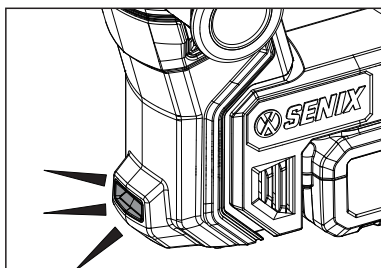

Fig.14

DRILLING IN WOOD OR METAL

- Set the mode selector to the symbol "M" and install a proper drill bit such as twist drill bit or wood drill bit.
- A stuck drill bit can be removed simply by setting the forward/reverse switch to reverse rotation in order to back out. However, the tool may back out abruptly if you do not hold it firmly.
- Always secure workpieces in a vise or similar hold-down device.
- Pressing excessively on the tool will not speed up the drilling. In fact, this excessive pressure will only serve to damage the

tip of your drill bit, decrease the tool performance and shorten the service life of the tool.

DRILLING IN CONCRETE OR MASONRY



WARNING:

There is tremendous and sudden twisting force exerted on the tool/drill bit at the time of hole break-through, when the hole becomes clogged with chips and particles, or when striking reinforcing rods embedded in the concrete. Always use the auxiliary handle and firmly hold the tool by both handles during operation. Failure to do so may result in the loss of control of the tool and potentially severe injury.

- Set the mode selector to "M" and install a drill bit specially designed to drill in masonry or concrete.
- Position the drill bit at the desired location for the hole, then pull the variable speed trigger. Do not force the tool. Light pressure gives best results. Keep the tool in position and prevent it from slipping away from the hole.
- Do not apply more pressure when the hole becomes clogged with chips or particles. Instead, run the tool at an idle, then remove the drill bit partially from the hole.
- By repeating this several times, the hole will be cleaned out and normal drilling may be resumed.

MAINTENANCE



WARNING:

Only perform cleaning and maintenance work according to these instructions!

All further works must be performed by a qualified specialist!



WARNING:

TO PREVENT SERIOUS INJURY FROM ACCIDENTAL OPERATION: Make sure the trigger is locked and battery pack is removed before performing any procedure in this section.

TO PREVENT SERIOUS INJURY FROM TOOL FAILURE: Do not use damaged equipments. If abnormal noise or vibration occurs, have the problem corrected before further use.

There are no user-serviceable parts in your power tool.

If any of following condition are found, stop using it and send it to the authorized service center for repair.

- leaking, swollen, or cracked battery pack
- loose hardware
- misalignment or binding of accessories.
- cracked or broken parts.
- any other condition that may affect its safe operation.

CLEANING

1. Clean dust from air vents.
2. Keep handles clean, dry and free of oil or grease.
3. Wipe up the chuck.
4. Remove stubborn dirt from housing with high pressure air (max. 3 bar) or a cloth.
5. Never immerse your tool in liquid or allow a liquid to flow inside them.



NOTE:

Do not use chemical, alkaline, abrasive or other aggressive detergents or disinfectants to clean this product as they might be harmful to its surfaces.

TRANSPORTATION

1. Only carry by its handle.
2. Protect from any heavy impact or strong vibrations which may occur during transportation in vehicles.
3. Secure to prevent it from slipping or falling over.

STORAGE

1. Clean thoroughly as described above.
2. Store in a dark, dry, frost-free and well-ventilated area that is inaccessible to children.
3. Store the tool separately with the battery pack.
4. The recommended storage temperature for tools and the batteries is 10°C ~ 26°C.
5. Use original package for storage or cover with a suitable cloth to protect against dust.

DISPOSAL

Waste product should not be disposed of with household waste. Please recycle where facilities exist.

Check with your local authority or retailer for recycling advice.

Users should clean up dust generated during operation to protect environment.



Electrical products should not be discarded with household products. Used electrical products must be collected separately and disposed of at collection points provided for this purpose. Talk with your local authorities or dealer for advice on recycling.

TROUBLESHOOTING

Suspected malfunctions are often due to causes that users can fix themselves. Therefore, check the product according to this section. In most cases the problem can be solved quickly.

Problem	Possible Cause	Solution
Product does not start	Forward/reverse switch at center locking position	Push forward/reverse switch to proper side
	Battery pack not properly attached	Reinstall the battery pack
Product does not reach full power	Battery pack capacity too low	Charge the battery pack
	Battery pack reaches its life cycle	Replace with new battery pack
Unsatisfactory result	Drill bit is dull	Replace with a new one
	Drill bit is not suitable for current operation	Use a proper bit

